

## Series KBF LQC | with ICH-compliant light source and light dose control

The main advantage of the BINDER KBF LQC series is the patented light photometry for photostability tests. Two 3D spherical sensors control the light dosage of UV-A and visible light. Once the desired light dosage is achieved, the chamber switches off automatically.



KBF LQC 240 model

### MAIN FEATURES

- Temperature range: 0 °C to 70 °C
- Temperature range with light: 10 °C to 60 °C
- Humidity range: 10 % to 80 % RH
- positionable illumination cassettes with ICH-compliant UV/Vis light source
- Independent light-dose control of UV-A and visible light with spherical sensors
- APT.line™ preheating chamber technology
- Humidity regulation with capacitive humidity sensor and vapor humidification
- Inner chamber made of stainless steel
- Intuitive touchscreen controller with time-segment and real-time programming
- Internal data logger, measured values can be read out in open format via USB

### AVAILABLE SIZES

Model	Interior volume [cu. ft.]	Online data sheets
KBF LQC 240	8.7	› <a href="https://go2binder.com/us-KBFLQC240">go2binder.com/us-KBFLQC240</a>
KBF LQC 720	24.7	› <a href="https://go2binder.com/us-KBFLQC720">go2binder.com/us-KBFLQC720</a>



### TIPS & TRICKS

Benefit from our many years of experience, as demonstrated in our technical papers:

- Tips & Tricks: › [go2binder.com/us-tips-tricks](https://go2binder.com/us-tips-tricks)  
 Case Studies: › [go2binder.com/us-case-studies](https://go2binder.com/us-case-studies)



Find all details online  
[go2binder.com/us-KBFLQC](https://go2binder.com/us-KBFLQC)

## ADVANTAGES AT A GLANCE



### **HOMOGENEOUS TEMPERATURE DISTRIBUTION**

Series KBF, KBF P, KBF LQC, KMF

BINDER APT.line™ preheating chamber technology ensures long-term operational stability even under full load.



### **INTUITIVE TOUCHSCREEN CONTROLLER**

Series KBF, KBF P, KBF LQC, KMF

State-of-the-art controller technology with time-segment and real-time programming with internal data recording.



### **HOMOGENEOUS LIGHT DISTRIBUTION**

Series KBF P, KBF LQC

Illumination cassettes with ICH-Q1B-compliant light sources provide flexible placement for photostability tests.

## TECHNICAL DATA

Description	KBF LQC 240	KBF LQC 720
Outer dimensions		
Width net [in]	36.45	49.3
Height net [in]	57.5	75.8
Depth net [in]	31.52	35.07
Internal Dimensions		
Width [in]	25.61	38.34
Height [in]	30.93	49.3
Depth [in]	19.11	22.69
Measures		
Interior volume [cu.ft.]	8.7	24.7
Net weight of the unit (empty) [lbs]	478	825
permitted load [lbs]	220	331
Load per rack [lbs]	66	99
Performance Data Temperature		
Temperature range with 100% illumination [°C]	10...60	10...60
Temperature range without illumination cassettes [°C]	0...70	0...70
Performance Data Climate		
Temperature range with 100% illumination [°C]	10...60	20...60
Temperature range without illumination cassettes [°C]	10...70	10...70
Temperature variation with illumination at 40 °C and 75 % RH [± K]	0.6	1.2
Temperature fluctuation with illumination at 40 °C and 75 % RH [± K]	0.2	0.2
Humidity range with illumination cassettes, with illumination [% RH]	10...75	10...75
Humidity range without illumination [% RH]	10...80	10...80
Humidity fluctuation with illumination at 40 °C and 75 % RH [± % RH]	2	2
Lightdata per Illumination Cassettes		
ICH compliant illumination for photo stability testing [lx]	7500	9000
ICH compliant illumination for photo stability testing [W/m²]	1.1	1.5
Electrical data		
Nominal power (version 230 V) [kW]	2.4	0
Nominal power (version 240 V) [kW]	2.4	3.5
Fixtures		
Number of shelves (std./max.)	2/7	3/12
Number of illumination cassettes (std./max.)	2/2	3/3

## ORDERING INFORMATION [Art. No.]

**Further details:** Go to [www.binder-world.com](http://www.binder-world.com) > Search > Enter Article Number

Voltage	Option model	KBF LQC 240	KBF LQC 720
200...230 V 1~ 50/60 Hz	Standard	9020-0332	9020-0334
200...240 V 1~ 50/60 Hz	Standard	9020-0333	9020-0335

► You will find a selection of options, accessories and services suitable for each product on page 18

EXTRACT OF FULLFILLED STANDARDS

- ICH Q1A(R2)
- ICH Q1B

TEMPERATURE-HUMIDITY CHART

KBF LQC 240

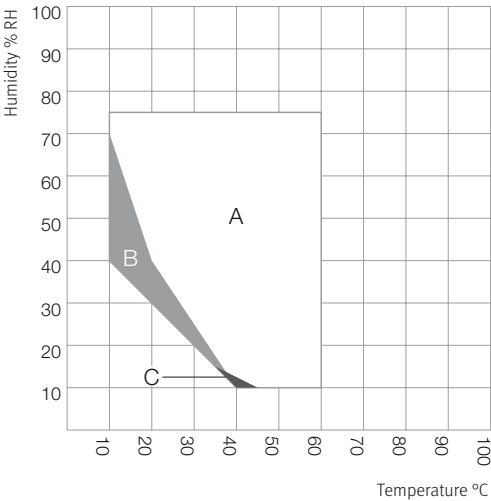

A: Guaranteed condensation-free range  
B: Time-limited operation (max. 24 hours)  
C: Deviations of technical data may be possible

KBF LQC 720

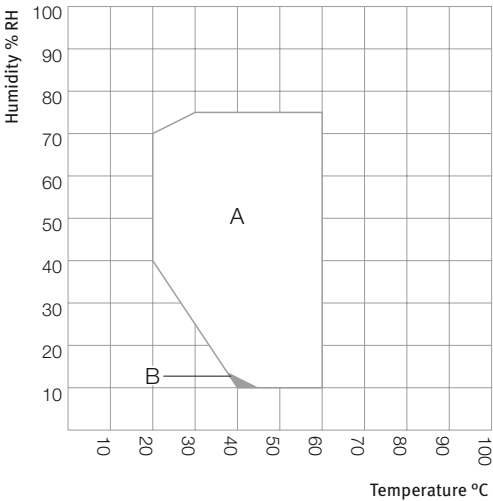

A: Guaranteed condensation-free range  
B: Deviations of technical data may be possible

DIMENSIONS INCL. FITTINGS AND CONNECTIONS [MM]

KBF LQC 240

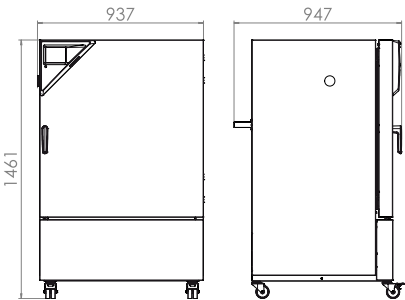

KBF LQC 720

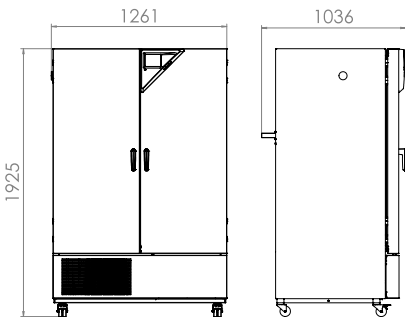

# EXCERPT FROM OPTIONS AND ACCESSORIES

<b>Access port with silicone plug</b>	<p>For introducing external measuring instruments. Large selection of different diameters and positions (left, right, or top)</p> <p>Series KBF, KBF P, KBF LQC, KMF</p>
<b>BINDER PURE AQUA SERVICE</b>	<p>System for preparation or complete desalination of tap water, complete set containing PURE AQUA 300 single-use cartridge, measuring device, and all necessary connecting parts</p> <p>Series KBF, KBF P, KBF LQC, KMF</p>
<b>Data Logger Kit TH</b>	<p>Independent temperature and humidity data logging. The tailored product solution contains helpful accessories: From the magnetic mounting of the data logger to the BINDER unit and securing sensor cable for accurate readings.</p> <p>Series KBF, KBF P, KBF LQC, KMF</p>
<b>LED light bar sets</b>	<p>LED light bars in three different lengths (30, 50, 90 cm) can be easily and variably positioned in the BINDER unit, including various attachment options and control unit. Additional light bars can be added as desired.</p> <p>Series KBF, KBF P, KBF LQC, KMF</p>
<b>Services</b>	<p>You can access our installation, maintenance, calibration, validation, or warranty services by taking out a Maintenance Service Agreement or by simply getting in touch when you need us. More information is available in the accessories and services chapter.</p> <p>Series KBF, KBF P, KBF LQC, KMF</p>
<b>BINDER INDIVIDUAL</b>	<p>Using a BINDER series production product as a basis, we develop individual solutions as a single unit or in small batches. All products are tested, certified, and supplied with a full functional guarantee and warranty. More information is available in the accessories and services chapter.</p> <p>Series KBF, KBF P, KBF LQC, KMF</p>

► All extras online [go2binder.com/us-options](https://go2binder.com/us-options)

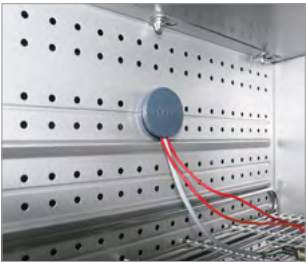

Access port with silicone plug



BINDER PURE AQUA Service



Data Logger



LED light strip sets